

DKSA60

SHOCK SUB

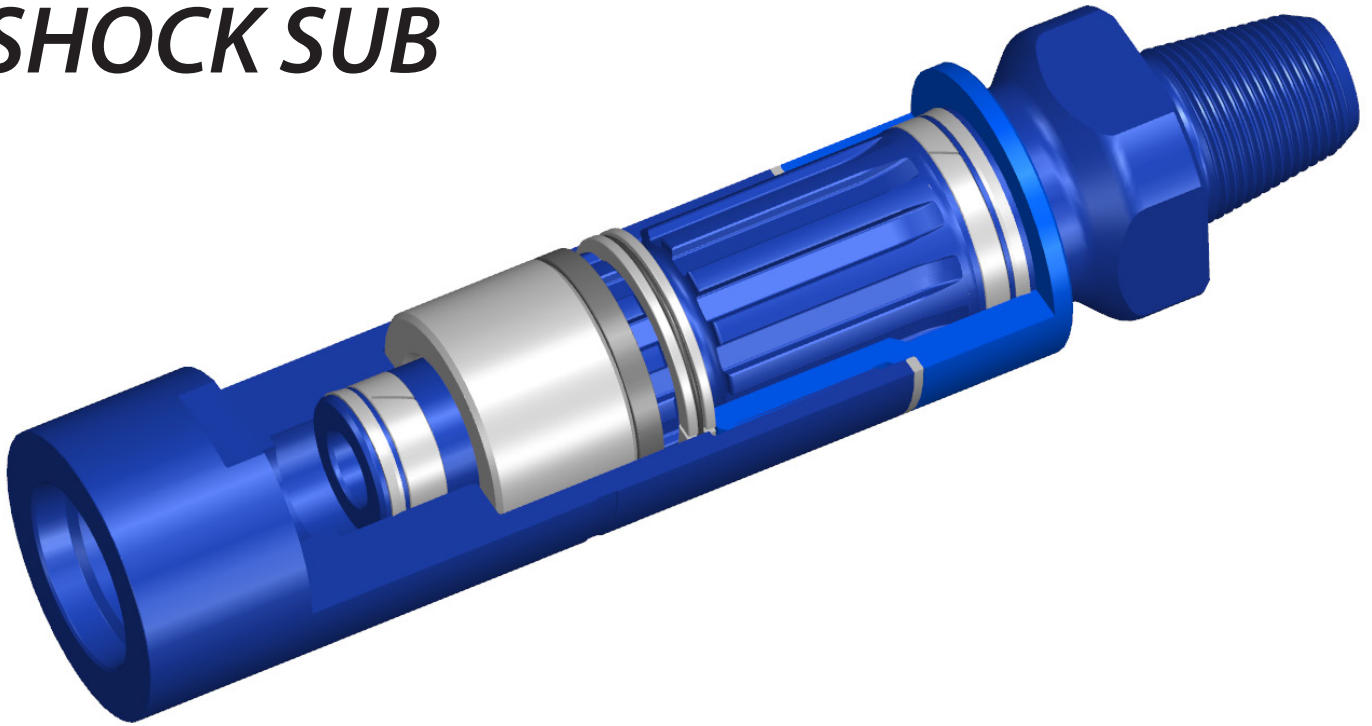

Key features

- Innovative design for Air and Water drilling applications
- Superior shock absorption
- Rig top drive protection through Hyper Absorption technology
- Increased rate of penetration
- More drive splines for better torque handling and wear resistance
- Manufactured in Mansfield, Texas

Parts List

| NO | Part Name | Qty | Part Number |
|--------------------------------|-------------------------|-----|---------------------|
| 1 | Splined Pin Drive Shaft | 1 | DKSA-P6601 |
| 2 | O-Ring Sealkit | 1 | DKSA-P6SEALKIT |
| 3 | Top Nut | 1 | DKSA-P6602 |
| 4 | Breakout Ring | 1 | DKSA-P6603 |
| 5 | Retainer Ring | 1 | DKSA-P6604 |
| 6 | Spacer | 1 | DKSA-P6605 |
| 7 | Buffer | 1 | DKSA-P6606 |
| 8 | Lower Sub Housing | 1 | DKSA-P6607 |
| Complete Shock Absorber | | | DKSA6-3.5PXB |

Technical Specifications

| | |
|----------------------------|----------------------|
| Thread Connection | 3.5" API REG PIN/BOX |
| Tool Length (in / mm) | 22.5 / 571.5 |
| OD (in / mm) | 5.75 / 146 |
| Weight w/o bit (lbs / Kg) | 90 / 40.8 |
| Max Torque (FT-lbs / M-Kg) | 4620 / 639 |

Exploded view

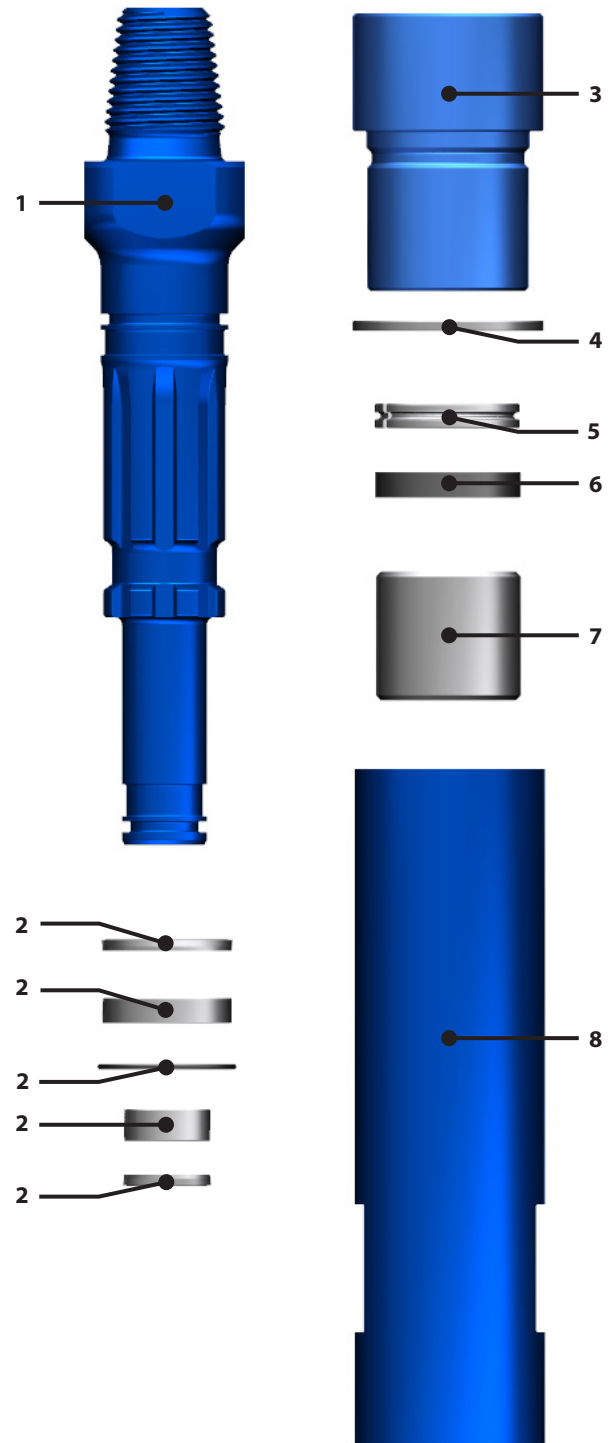

MAINTENANCE REQUIREMENTS

****CAUTION! ALWAYS USE PROPER TOOLS AND PROTECTIVE WEAR WHEN BREAKING OUT ANY DRILLING TOOLS ****

1. Break out only on wrench flats on splined pin drive shaft and wrench flats on sub housing. Do not break out on the top nut!
2. Visually inspect metal components for excessive wear.
3. Visually inspect pin connection for fatigue / cracking.
4. Replace all soft packing with DKI XT pro series soft pack kit every 180 days or 500 drilling hours.
5. Wear limit exceeded when dimensions on splines exceed 2.5 mm.
6. Lubricate all components using DKI ECO-lube to ensure best performance and longest tool life.
7. Reassemble as shown in diagram and torque up using proper tools on the wrench flats.